



# Knox Key Switch 3500 Series

for Emergency Override



Gated communities, apartment complexes, parking garages, pedestrian gates and industrial receiving areas are just a few applications of the Knox electric override key switch. It also controls emergency power system shutoff and can be ordered with single or dual key options for fire, EMS and law enforcement access.

## Features

- Single or dual key switch
- Fire or law enforcement identification labels
- One position, two position or momentary switch
- Face plate and lock cover ensure weather resistant operation.

## Electrical Data

SWITCH: SPDT

7 A res., 4 A ind., (sea level), 28 VDC.

7 A res., 2.5 A ind., (50,000 ft.), 28 VDC.

7 A res. or ind., 115 VAC., 60 Hz.

U.L. and CSA listed: 7 A, 250 VAC.

Temperature tolerance up to +180° F.

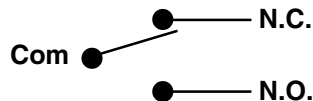

## Knox Rapid Entry System

The Knox Company manufactures a complete line of high security products including Knox-Boxes, key vaults, armored cabinets, key switches, padlocks, locking FDC caps, the Knox-Scan infrared heat sensor, and an electronic master key security system. For more information or technical assistance, please call Customer Service at 1-800-552-5669.

## Single Switch Model 3502

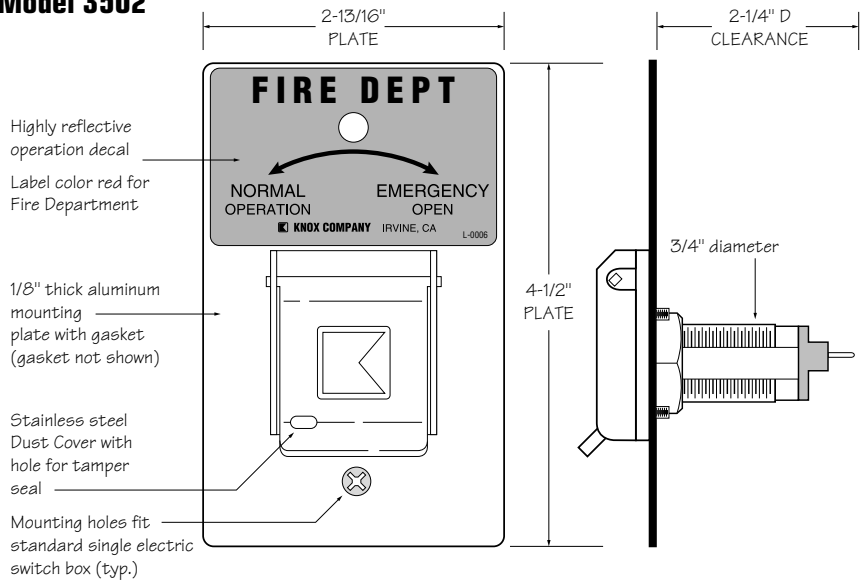

## Dual Switch Model 3503

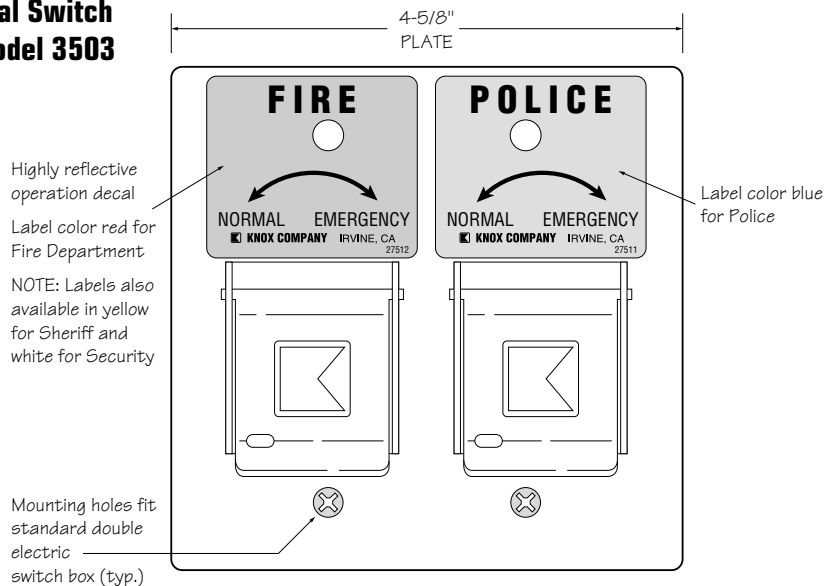

## Order Specifications

Dimensions: Requires 2 1/4" recessed depth x 3/4" diameter  
 Switch: S.P.S.T.; 7A res, 4A ind., key removable two position.  
 Mounting: Key switch is designed to be recess mounted.  
 P/N: 3500 Series Knox Key Switch (mfr's cat. ID)  
 Mfr's Name: KNOX COMPANY

© copyright 2004. Knox Company



S40-0005 09/2004